



INNOVATIVE | RELIABLE | EFFICIENT

DISCOVER A NEW LEVEL OF EFFICIENCY

RENEWABLE HOME HEATING RANGE

HEAD OFFICE

Warmflow House
Lissue Industrial Estate
Moira Road
Lisburn
BT28 2RF
Northern Ireland

T: +44 (0) 2892 621 515
sales@warmflow.co.uk

GREAT BRITAIN

Warmflow House, Unit C4
Stafford Park 4,
Telford,
TF3 3BA
England

T: +44 (0) 1952 607 750
salesgb@warmflow.co.uk

INTERNATIONAL

Avda. de Los Castros, 33
Portal 2 – 1B
Santander
39005
Cantabria
Spain

T: +34 (0) 942 140 623
info@warmflow.es



CERT No. FM29884



★ Trustpilot



Warmflow Engineering Company Limited is a family owned company where reputation and integrity are paramount. We maintain a policy of continuous product improvement and reserve the right to change specification without notice. The statutory rights of the consumer are not affected. This brochure should only be used for sales purposes. Please consult the installation instructions, available on request, before installing or specifying a Warmflow product.

REV A 7495 ISSUE B

www.warmflow.co.uk

50 YEARS OF HEATING

For 50 years, Warmflow has created innovative, award-winning heating products for homes in Northern Ireland and Great Britain.

All Warmflow products are made at our state of the art manufacturing facility in Lisburn, Northern Ireland. Our extensive range of home heating products offer value for money, fuel efficiency, ease of installation and top class customer care.

Our comprehensive product portfolio includes the UK's only AA rated boiler, a choice of highly efficient, intelligent renewable products and a selection of cylinders which will satisfy the needs of the most demanding households.

At Warmflow we pride ourselves on leading the way in innovation, working with customers to ensure that:

- we manufacture products which are easy to install and service
- our products are made using only the highest quality materials
- they deliver the highest available efficiency levels and cost savings.



Our products have been independently tested and accredited. Our range of appliances exceed the minimum ErP efficiency requirements and comply with Document L1A, L1B (England & Wales), The Building Standards (Scotland) Regulations Section 6, Approved Document Part F (Northern Ireland) and with the HARP efficiency requirements for Part L (Republic of Ireland).

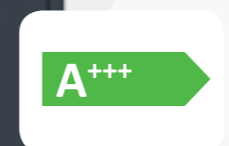

WARMFLOW Zeno

AIR SOURCE

Air to water heat pumps are an increasingly popular choice for homeowners. They can be easily integrated into heating systems, offer excellent energy savings and can help reduce your carbon footprint. Designed to work in lower temperature conditions they are suitable for installation in a wide range of accommodation including smaller houses to larger properties. Electricity is required to operate the appliance resulting in approximately 75% of the energy used coming from renewable sources helping to reduce your carbon footprint.

Using technology which is similar to that which is used in a common household fridge, our Zeno heat pump harnesses the natural heat energy from the air by blowing it through a highly finned evaporator coil. The heat pump then increases the temperature and the heat is used to provide heating & hot water for your home. All Warmflow Zeno air source heat pumps come with Warmlink, Warmflow's cloud based remote control technology which provides effortless and easy to use remote control access for engineers.

Why Warmflow Zeno?



3 MODELS
Zeno 8kW, 12kW & 20kW

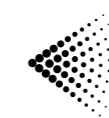

ENHANCED VAPOUR INJECTION (EVI) TECHNOLOGY
Extends the operating envelope of the unit.



QUIET OPERATION
All products are Quiet mark approved with super quiet operation. Sound level as low as 54db (A).



ELECTRONIC CONTROLLED EXPANSION VALVES
Optimising system efficiency by allowing the heat pump to run at a range of flow temperatures and capacities.



VARIABLE SPEED-INVERTER DRIVEN COMPRESSOR
Low noise, high efficiency Panasonic rotary compressor; the heart of the system.



HIGH FLOW HEAT EXCHANGERS WITH LARGE SURFACE AREA
Maximising the heat supplied to the property whilst maintaining high flow rates for efficient operation.



USER-FRIENDLY TOUCHSCREEN INTERFACE
Covering all aspects of heat pump and system control; the brain of the system.



LOW CURRENT
Designed to run from a standard single-phase domestic electricity supply.



BUILT IN HIGH EFFICIENCY PUMP
Fully integrated Grundfos high efficiency pump for the heating circuit.



HIGH TEMPERATURE OUTPUT
Flow temperature up to 60°C means domestic hot water (DHW) can be produced without the need for additional heat sources.



INSTALLATION & CONTROL ACCESSORIES AS STANDARD
Hydraulic kit includes: 1" flexibles x 2, 1" ball valves x 2, 1" elbows x 2, 1" Y strainer & Manual. Accessories kit includes: Controller, mounting plate, 10m extension cable, DHW Cylinder sensor (10m), Anti vibration mounts x 4.



INSTALLER FRIENDLY
Includes a number of installation friendly features as standard which will help facilitate a smooth installation.

TECHNICAL SPECIFICATION AND PERFORMANCE

AS01-R32

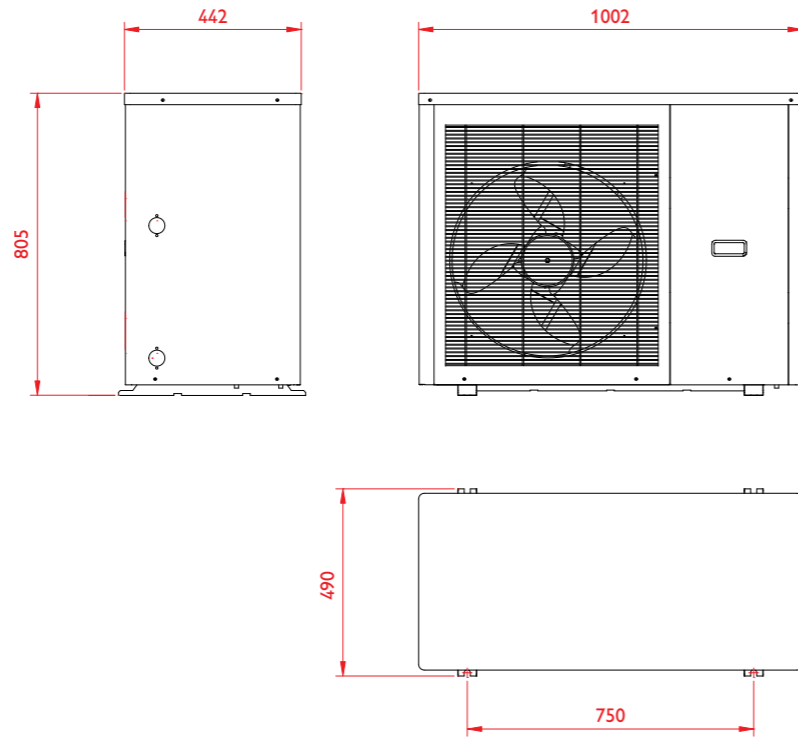

AS02-R32

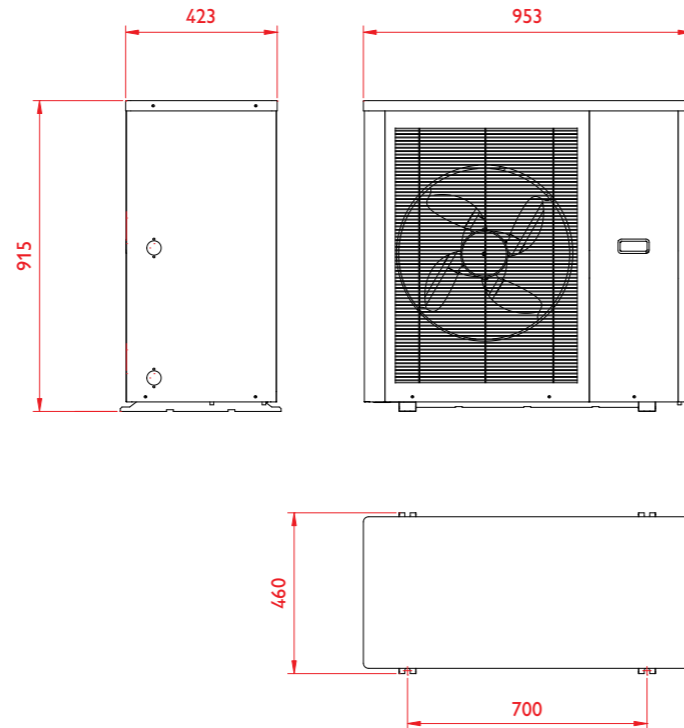

AS03-R32

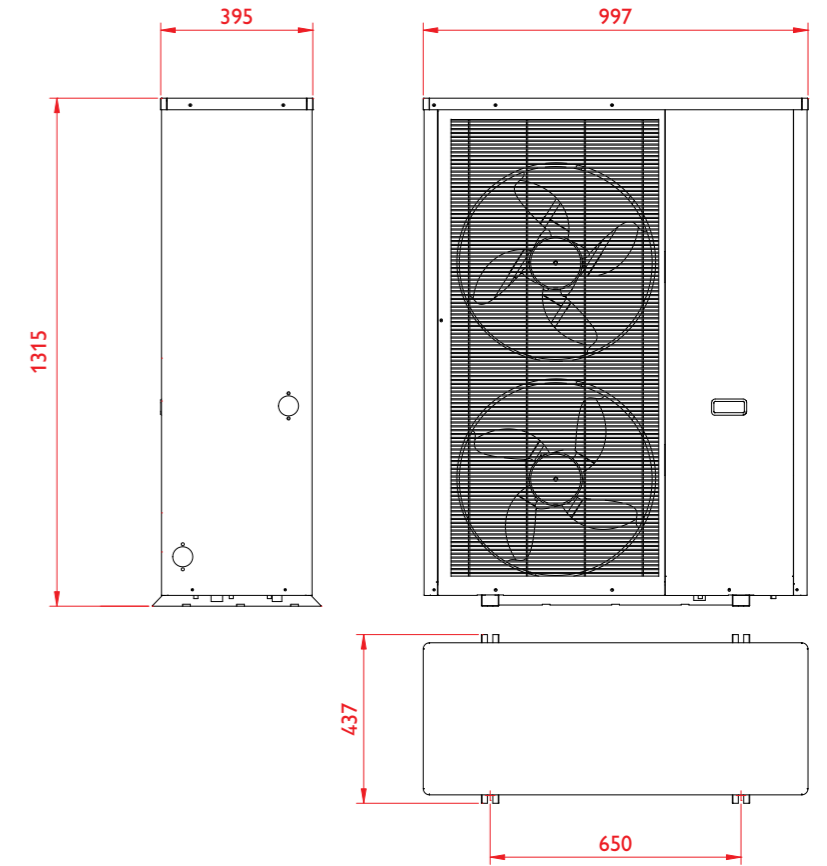

SPECIFICATIONS

PRODUCT DATA		AS01	AS02	AS03
Dimensions (mm)	Width	1002	955	1000
	Depth	490	460	440
	Height	805	915	1315
Weight (kg)		90	108	157
Electrical Supply		230V Single Phase@50Hz	230V Single Phase@50Hz	230V Single Phase@50Hz
Maximum Current (Amps)		13	22	33
Nominal Sound Level (dBA)*		37.54	42.55	44.58
Performance (Max)	kW @ A7W35	8.3	12.5	20.5
	COP @ A7W35	4.58	4.35	4.67
	kW @ A7W55	6.6	10.1	15.4
	COP @ A7W55	2.68	2.67	2.51
	kW @ A-7W35	5.6	8.5	13.8
	COP @ A-7W35	3.22	2.88	3.48
	SCOP @ W35	4.55	4.02	4.06
	SCOP @ W55	3.20	3.23	3.23
ErP Efficiency Class (35°C / 55°C) [^]		A+++ / A++	A++ / A++	A++ / A++
Operating Temp (°C)	Ambient Air, min/max	-25/43	-25/52	-25/52
	Heating, min/max	20/60	20/60	20/60
Flow Rates (l/m)	Heating, min/max	10/20	16/30	28/60
Refrigerant	Type	R32	R32	R32
	Charge (kg)	1.30	1.70	2.00
Connections	Heating Flow & Return	1" female BSP	1" female BSP	1¼" female BSP



A RANGE OF PACKAGES TO SUIT ALL YOUR INSTALLATION REQUIREMENTS

All of our Zeno air source heat pumps come with a basic kit which comprises of a touch screen, intelligent controller, factory fitted Grundfos circulating pump, Y strainer, flexi hose kit, isolating ball valve and 2 x 1" male to female elbows.

In addition, we offer a range of custom packs which include our very own Warmflow branded twin coil heat pump cylinder offering further value and a 1 stop shop to ensure your installation is as easy as possible. All the packs have been designed to enhance value for our customers and include only the finest quality, market leading branded goods.

Our range of custom packs are detailed in the tables over.

ZENO INVERTER DRIVEN AIR SOURCE HEAT PUMP MODELS

Includes controller, pump, heated drip tray, 1" x Y strainer, 1 x flexi hose kit, 2 x 1" isolating ball valve, 2 x 1" Male to Female Elbows

Code	Description
AS01	Zeno 8kW ASHP
AS02	Zeno 12kW ASHP
AS03	Zeno 20kW ASHP

PACK 1

ZENO INVERTER DRIVEN AIR SOURCE HEAT PUMP

Includes Adey Magnclean 1" BSP, Ethylene Glycol conc 25l drum, 24ltr round expansion vessel c/w bracket, Advantay 50ltr insulated buffer tank, Flexi foot support (x2)

Code	Description
AS01 K1	Zeno AS01 with Pack 1
AS02 K1	Zeno AS02 with Pack 1
AS03 K1	Zeno AS03 with Pack 1

PACK 2

ZENO INVERTER DRIVEN AIR SOURCE HEAT PUMP & 250ltr CYLINDER

Includes 250ltr twin coil heat pump cylinder, Full flow 3 port valve body & actuator, Adey Magnclean 28mm, Ethylene Glycol conc 25l drum, 24ltr round expansion vessel c/w bracket, Advantay 50ltr insulated buffer tank, Flexi foot support (x2)

Code	Description
AS01 K2	Zeno AS01 with Pack 2
AS02 K2	Zeno AS02 with Pack 2
AS03 K2	Zeno AS03 with Pack 2

PACK 3

ZENO INVERTER DRIVEN AIR SOURCE HEAT PUMP & 300ltr CYLINDER

Includes 300ltr twin coil heat pump cylinder, Full flow 3 port valve body & actuator, Adey Magnclean 28mm, Ethylene Glycol conc 25l drum, 24ltr round expansion vessel c/w bracket, Advantay 50ltr insulated buffer tank, Flexi foot support (x2)

Code	Description
AS01 K3	Zeno AS01 with Pack 3
AS02 K3	Zeno AS02 with Pack 3
AS03 K3	Zeno AS03 with Pack 3



WARMFLOW WARMLINK

Setting up WarmLink access on your smartphone, tablet or electronic device couldn't be easier with a simple to use app available on google play or apple app store. Simply download the app, connect your device and start enjoying the benefits of remote control access to your Zeno air source heat pump.

All Warmflow Zeno air source heat pumps come with a communication module with built in SIM card which automatically connects to the cloud when the heat pump is activated. Simply scan the barcode using the WarmLink app to connect to your heat pump.

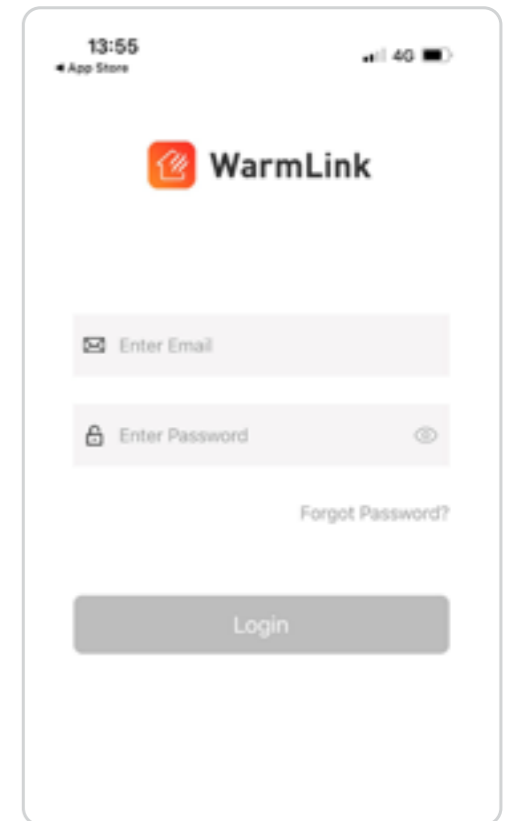

WarmLink is Warmflow's cloud based technology which provides effortless, easy to use remote control technology for homeowners and engineers. WarmLink allows users to control and monitor their Warmflow Zeno air source heat pump remotely or from the comfort of their sofa.

WarmLink is easy to use and offers a range of features including:



APP CONTROL

Fully control your appliance via your smartphone, tablet or PC.



ERROR CODES

In the unlikely event of a fault, your engineer will be able to remotely review error codes allowing for more efficient diagnosis and speedy response



EASY CONTROL

Easy control of the heating and hot water for your appliance from anywhere in the world to ensure maximum comfort in your home



The WarmLink user interface is now included as standard with all Warmflow Zeno air source heat pumps ensuring the smooth and efficient running of your appliance for many years to come.

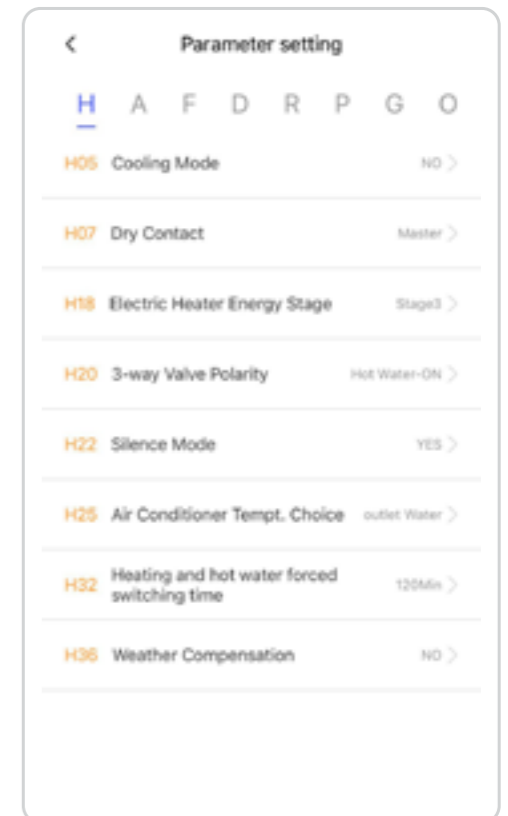
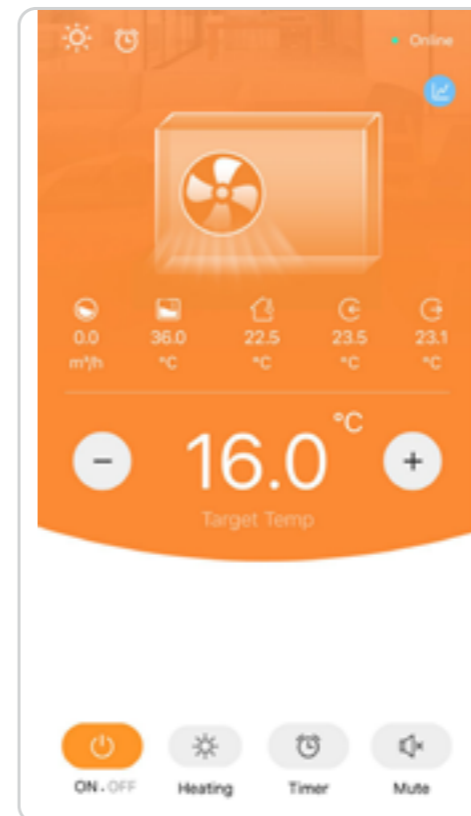

WARMFLOW Zeno

GROUND SOURCE HEAT PUMPS

What is a Ground source heat pump (GSHP)?

Ground source heat pumps (GSHPs) use a loop of pipe, called a ground loop, which is buried in your garden to extract heat from the ground. Heat from the ground is absorbed into the fluid and then passes through a heat exchanger into the heat pump which then transfers heat into your radiators or underfloor system. The length of the ground loop depends on the size of your home and the amount of heat your home requires to remain warm and cosy during the long winter months.

The Warmflow Zeno ground source heat pump is one of the most efficient and intelligent heat pumps in Europe with an SCoP of up to 5.08%! Independent tests have shown an SCoP of up to 5.08% which means that for every 1kW of electricity consumed, 5.08kW of heat are produced resulting in an ErP rating of A+++.

Why Warmflow Zeno?

- 2 MODELS**
 Zeno 2-8kW & 4-18kW
- SINGLE PHASE ELECTRICITY SUPPLY UP TO 18kW**
 Designed to run from a standard single-phase domestic electricity supply.
- QUIET OPERATION**
 All products are Quiet mark approved with super quiet operation. Sound level as low as 54db (A).
- VARIABLE SPEED-INVERTER DRIVEN COPELAND COMPRESSOR**
 Low noise, high efficiency Copeland compressor; the heart of the system.
- USER-FRIENDLY INTERFACE**
 Powerful programmer with unique features to assist the installation, operation and servicing.

- VARIABLE SPEED, HIGH EFFICIENCY PUMPS**
 Fully integrated, variable speed, high efficiency pump for the heating & brine circuits modulates flow to match heating demand and overcome hydraulic resistance whilst maintaining peak efficiency.
- INSTALLATION ACCESSORIES AS STANDARD**
 Includes flexible hoses, filters and 3 port diverting valve. Built-in system kit (inc expansion vessel) for heating systems up to 150L
- ELECTRONIC CONTROLLED EXPANSION VALVES**
 Optimising system efficiency by allowing the heat pump to run at a range of flow temperatures and capacities.
- HIGH FLOW HEAT EXCHANGERS WITH LARGE SURFACE AREA**
 Maximising the heat supplied to the property whilst maintaining high flow rates for efficient operation.
- HIGH TEMPERATURE OUTPUT**
 Flow temperature up to 65°C means domestic hot water (DHW) can be produced without the need for additional heat sources.



A+++

UP TO 18kW
Single phase electricity supply

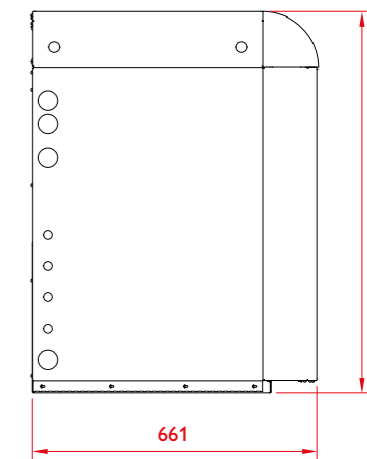

SPECIFICATIONS

PRODUCT DATA		GS08	GS16
Dimensions (mm)	Width	590	590
	Depth	660	660
	Height	890	890
Weight (kg)		125	130
Electrical Supply		230V Single Phase@50Hz	230V Single Phase@50Hz
Maximum Current (Amps)		30	40
Nominal Sound Level (dBA)*		58	55
Nominal Performance (EN 14511)	kW @ B0W35	7.59	11.63
	COP @ B0W35	4.41	5.08
	kW @ B0W45	7.72	12.00
	COP @ B0W45	3.63	4.10
	kW @ B0W55	7.91	12.32
	COP @ B0W55	3.00	3.34
	ErP Efficiency Class (35°C / 55°C) [^]	A++ / A++	A++ / A++
Operating Temp (°C)	Heat Output Range	2.5 – 8 kW	4.5 – 18 kW
	Brine Flow, min/max	-5/15	-5/15
Flow Rates (l/m)	Heating Flow, min/max	30/65	30/65
	Brine, min/max	10/45	10/75
Refrigerant	Heating, min/max	8/34	8/60
	Type	R410A	R410A
Connections	Charge (kg)	2.60	3.10
	Brine Flow & Return	1½" female BSP	1½" female BSP
	Heating Flow & Return	1¼" female BSP	1¼" female BSP

KEY FEATURES

At Warmflow we pride ourselves on our innovation and customer focus so we designed our biomass boiler to meet all possible performance demands.



BIOMASS WOOD PELLET BOILERS

Biomass boilers are very similar to conventional gas boilers that you will be familiar with, providing you with space heating and hot water for the entire home, but instead of using gas to produce the heat, they combust sustainably sourced wood pellets.

Using wood in place of fossil fuels helps to prevent long-term climate change, since the carbon dioxide released during the combustion was actually absorbed while the tree was growing, so they are essentially carbon neutral.

The Warmflow Zeno biomass wood pellet boiler has been uniquely designed for ease of installation & homeowner use ensuring it meets all performance demands. Intelligent control and design ensures maximum efficiencies are achieved with long intervals between cleaning and maintenance.

USER FRIENDLY CONTROL PANEL

WS18 / WP18	
Output	4~18kW; Modulating
Flue Options	Black powder coated conventional flue system
Conventional flue size (mm)	100
EN303-5 Efficiency class	Class 5
Height (mm)	1135
Depth (mm)	1170
Width (mm)	650
Service access	Front, Top & Sides
Circulating pump	Factory-fitted UPM 25-75



WOOD PELLET FLUE SYSTEM & FLUE KIT ACCESSORIES

The 'Easy-Fit' twin wall metal flue system has been specifically designed for use on biomass appliances. The inner wall is manufactured from high grade aluminium with the outer wall finished in a weather-resistant and durable black powder coating.

Utilising a push-fit system ensures ease of use and quick installation. The system is also suitable for internal use and can be used in conjunction with our Roof Flashings kits as required.



Pitched Roof Flashing
4348

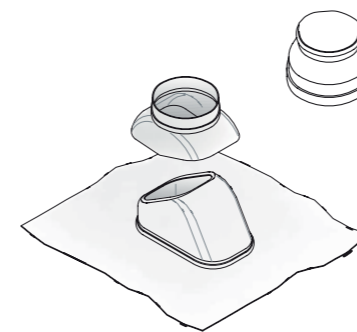

Flat Roof Flashing
4349

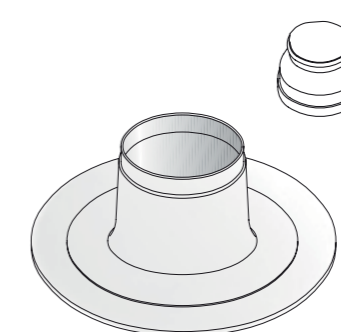

Vertical Flue Kit 080/100
4142

- Included with every WP18 is:
- 500mm Extension
 - Flue Terminal (584mm)

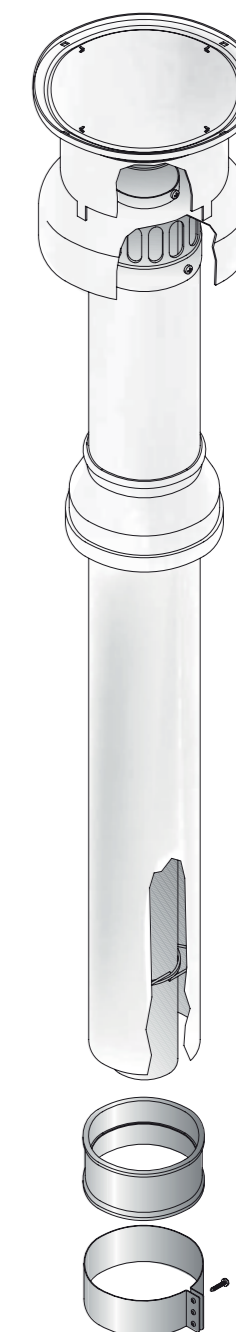

45° Bend
4187



Wall Brackets

- Supporting Collar for pipes (4189 standard)
- Supporting Collar for pipes (4347 extended)

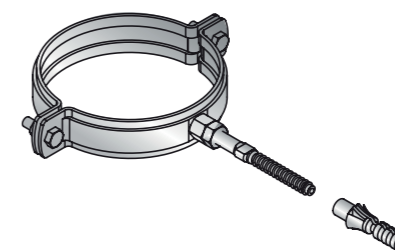

Concentric Extension

- 4181 - 500mm
- 4188 - 1000mm

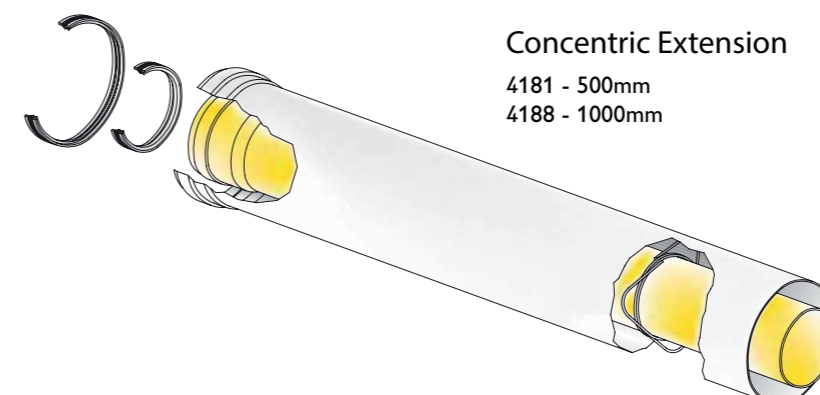

KEY FEATURES CONTINUED

- Can be fitted in a garage, an outbuilding or outdoors.
- 60 litre boiler capacity eliminates the need for a buffer tank in the majority of installations.
- Only uses ENPlus A1 pellets.
- High durable, black powder-coated, push-fit flue with options.
- Ceramic ignitor with intelligent software to give quick and reliable ignition.
- Fits through a doorway and takes up similar footprint to a slimline oil tank, saving you valuable space.
- Smart induced draught fan technology with lambda control continually adjusts to give you the best efficiency all the time.
- Auto restart after power cuts – no manual intervention needed so you won't be waking up to cold water and a cold house after an overnight power cut while you were sleeping.
- User-friendly, menu-based controller guides you through every step. Future-proofed to allow new software developments such as smart phone technology to be uploaded at routine services.
- Installer friendly – simplified wiring.
- Simple flow and return plumbing.
- Optional patent pending installation buggy kit, making it easy to move into place.



Easy installation in a matter of hours



- DEFRA exempt
- Approved by MCS
- HETAS approved appliance scheme



Eligible for government grants

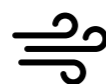

Exempt from the Clean Air Act



WARMFLOW
Zeno



TWIN COIL TW300UV-HP

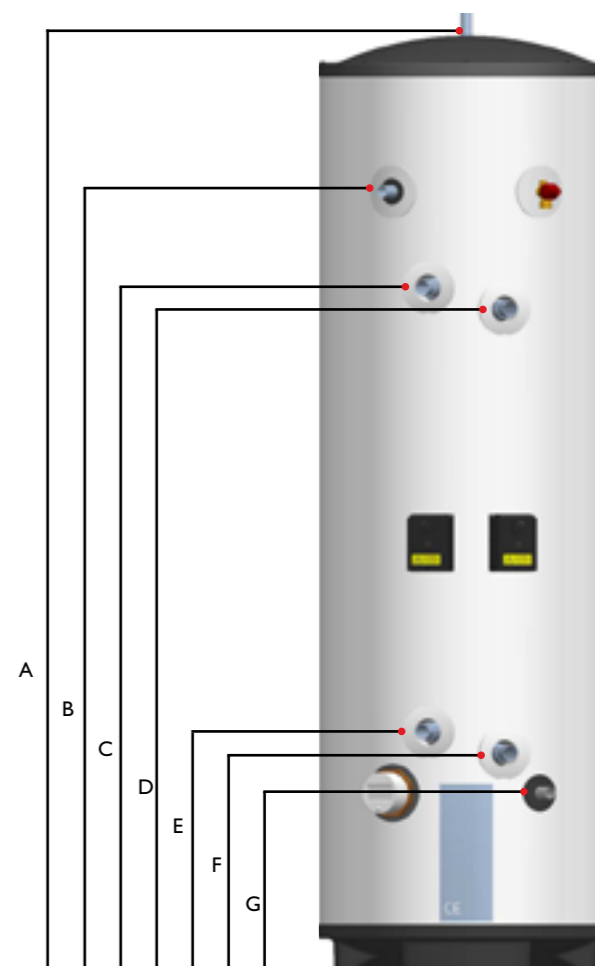

WARMFLOW HEAT PUMP CYLINDERS

The Warmflow cylinder range has been designed to satisfy the needs of even the most demanding household. The innovative design of our range of heat pump cylinders ensures that you benefit from the largest hot water volumes, shortest heat-up times and lowest possible heat losses.

From the coil heat exchangers to the high performance foam insulation, our cylinders work of mains pressure so they provide outstanding water flow rates. Rather than using thin wall corrugated flexible tubes for our heat exchanger coils, we use rigid coil exchangers formed from high quality stainless steel delivering improved stability, quality and durability.

We use a thick layer of high quality polyurethane insulation in our cylinder range and is amongst the lowest fully certified heat loss levels currently on the market, saving precious fuel and reducing carbon dioxide emissions. Our insulation is also CFC/HCFC-free, has a zero Ozone Depletion Potential (ODP) and a Global Warming Potential of only 2.

HEAT PUMP CYLINDER

	TW250UV-HP	TW300UV-HP
DIMENSIONS		
(A) Height	1767	2077
(B) Secondary return connection (mm)	1473	1783
(C) Coil A upper connection (mm)*	1294	1326
(D) Coil B upper connection (mm)*	1254	1286
(E) Coil A lower connection (mm)*	456	488
(F) Coil B lower connection (mm)*	416	448
(G) Cold water inlet connection (mm)	338	338
OPERATING DATA		
Operating Pressure (bar)	3	
Maximum Design Pressure (bar)	6	
Capacity (L)	250	300
Standing heat loss (kWh/24h)	1.92	2.07
PERFORMANCE		
Coil A rating @ 15 l/min (kW)	20.2	21.0
Coil B rating @ 15 l/min (kW)	22.0	20.7

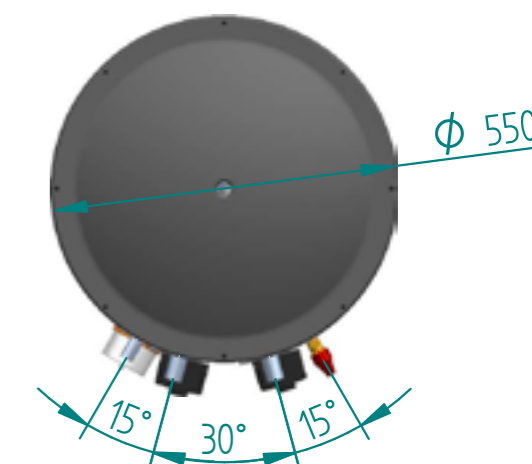

*For heat pump installations both coils A & B Should be used in parrallel



WARMFLOW CUSTOMER SERVICE

Total peace of mind with our dedicated Customer Service team

All Warmflow Agentis oil boilers come with a 2 year parts and labour warranty and a 5 year warranty on the heat exchanger as standard. These can easily be upgraded to a 5 year parts and labour warranty*, providing peace of mind that your appliance is in safe hands should any problems occur.

Our dedicated and knowledgeable customer support team is on hand to provide expert support before, during and after-sales, to ensure that your queries are addressed in a timely fashion. All Warmflow products must be registered in line with terms and conditions otherwise warranty may be invalid.

*Full details of terms and conditions of warranty for your Warmflow product are available at www.warmflow.co.uk.



TRAINING COURSES

Become a Warmflow Connect installer and gain a number of benefits including a free 5 year parts and labour warranty* on all of your Warmflow Agentis oil boiler installations.



At Warmflow we offer a range of oil and renewable training course to suit all requirements at our training centres around the UK.

For more information please email salesgb@warmflow.co.uk or call 01952 607750

HEAD OFFICE GB OFFICE
Lisburn Telford

TRAINING CENTRES

1. Lisburn
2. Telford
3. Exeter
4. Hailsham
5. Langport
6. York
7. Cumbria
8. Scotland
9. Wrexham
10. Norwich

*Connect Installer scheme subject to T&Cs. Visit www.warmflow.co.uk for more information